

# P400 SERIES

1. DIMENSIONING SHALL BE INTERPRETED PER ANSI Y14.5M-1994
2. CONTACT RETENTION FORCE : 1.36kgf MIN. PER CONTACT
3. OPERATION TEMPERATURE : -40°C TO +105°C

## ORDERING INFORMATION

P400 - □□ - □

No. of Single Row Pos.      Contact Area Plating

0 : 100μ" Min. Tin/Lead Plating Over All  
 2 : Gold Flash Over All  
 8 : 15μ" Min. Gold

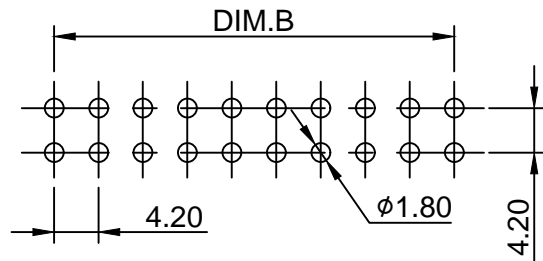
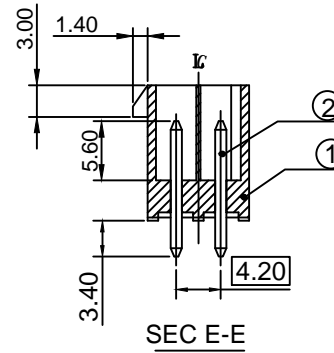
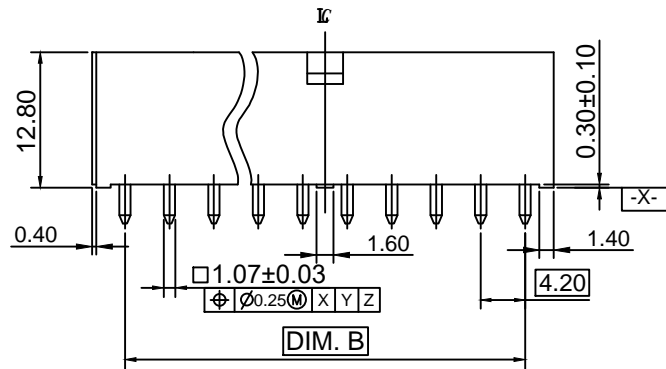
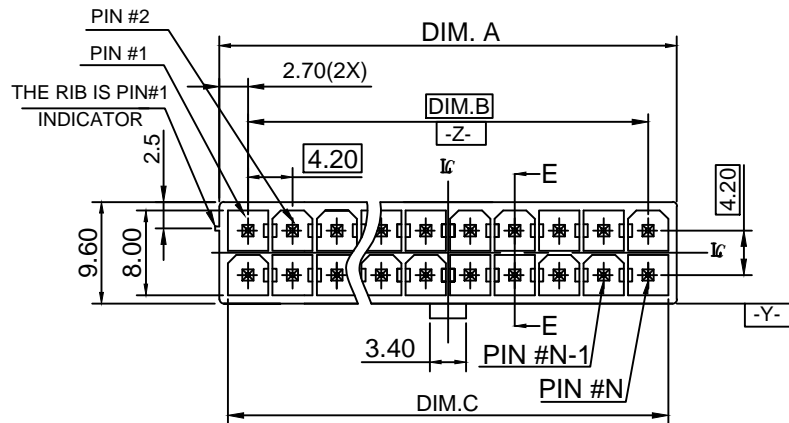

RECOMMENDED PCB LAYOUT

P400 - 12 - □	12/24	51.6	46.20	50.0	46.20
P400 - 11 - □	11/22	47.4	42.00	45.8	42.00
P400 - 10 - □	10/20	43.2	37.80	41.6	37.80
P400 - 08 - □	8/16	34.8	29.40	33.2	29.40
P400 - 04 - □	4/8	18.0	12.60	16.4	12.60
Part No.	No. of Pos.	Dim. A	Dim. B	Dim. C	Dim. D

①	1	Insulator : PA6T UL94V-0 Color : Black
②	BASE ON POS.	Contact : Brass
ITEM	Q'TY	DESCRIPTION
COMPONENT PARTS LIST		

Title : Customer Drawing    Type : Power Connector		彩電企業股份有限公司 CHARTRON INCORPORATION				
Part No. : P400 Series						
Description : P400 Power Base Connector Pitch 4.20 mm		Tolerances Unless Otherwise Specified :				
		X. ± 0.50	.X ± 0.38	.XX ± 0.25		
		X. ° ±	.X ° ±	.XX ° ±		
DWG No. : 010 - 0002 - 492	Date : 01 - Aug. - 2004		Dim.	Scale	Sheet	Rev.
APPD. : James C.	CHK. : Connie Z.		DRW. : Bryant C.	mm	N/A	1 of 1